

-->

ChatGPT Edu

Last Modified on 11/05/2025 12:12 pm EST

ChatGPT Edu adds enterprise-level security, enhanced privacy, and data agreements to ChatGPT, the leading provider of generative AI, ensuring that it can be leveraged responsibly with University data. **No data entered in the Wharton ChatGPT Edu workspace is used for training Open AI's models.**



ChatGPT Edu also features:

- Access to the latest ChatGPT models
- Sharable custom GPTs within the workspace
- DALL-E image creation

Before you start:

ChatGPT Edu is available to:

- Standing Wharton Faculty
- Full-time Wharton Staff
- Wharton MBA and PhD students
- University students while enrolled in Wharton graduate courses

Note: **ChatGPT Agent** is currently not enabled in our ChatGPT Edu workspace, but may become available in the future. Please check back for updates.

As of August 15, 2025, ChatGPT5 is available.

Table of Contents

- [ChatGPT Edu Benefits](#)
- [Chat GPT Account Access](#)
- [Security and Data](#)
- [Features](#)
- [Resources](#)
- [Questions?](#)

No confidential data should be uploaded to any ChatGPT workspace outside the Wharton ChatGPT Edu space. If you have any questions about this, please contact our Information Security Office. Refer to the [Security and Data](#) section for more information.

ChatGPT Edu Benefits

Wharton ChatGPT Edu includes everything available in a free, personal account and adds several enhancements.

Enhanced Privacy

Data entered into the Wharton ChatGPT Edu workspace is never used by OpenAI to train its AI models. This means some University confidential data can be used with Wharton ChatGPT Edu. Please see the above section on “Security and Data” for more information.

Proven Models

Wharton ChatGPT Edu accounts have access to the latest ChatGPT models that have been tested and proven. You can also switch to older models with a single click, if those models are better suited to the task at hand.

Custom GPTs

GPTs are a custom-tailored version of ChatGPT that you can create with no code to accomplish various tasks. These GPTs can be shared with other Wharton ChatGPT Edu users within the Wharton ChatGPT Edu Workspace - see [How to share GPTs within workspaces | OpenAI Help Center](#)

Custom GPTs created within the Wharton ChatGPT Edu workspace **cannot be exported** for access by ChatGPT users external to our workspace.

APIs

Wharton ChatGPT Edu includes API access for faculty and staff (students must work with a sponsoring faculty or staff member willing to both fund and accept risks for projects requiring API access).

If you have a project that requires API access, please contact your [Wharton Computing Representative](#).

Refer to the [ChatGPT Edu API Usage](#) section below for API security information.

Chat GPT Account Access

[Top](#)

Wharton's ChatGPT Edu workspace is available to some members of the Wharton community. The following table lists who has access and how long that access lasts:

Wharton Community Member Type	
Length of Access	
Standing Faculty & Full-time Staff	
Contingent on an active affiliation with Wharton.	
MBA, WEMBA, and PhD Students	
From enrollment until graduation.	
University students and TAs, while enrolled in Wharton graduate courses	
For the duration of the enrolled course.	

Once faculty, staff, Phd, and MBA students have an active PennKey account and have the appropriate Penn

affiliations (e.g. appear in the HR system or are actively enrolled as a student), they will get an email invite directly from ChatGPT.

Active Accounts

In order to maintain an active ChatGPT account, you must accept the invitation to the Wharton ChatGPT workspace, and actively use it.

If you don't send any messages for six months, your account will be considered **inactive**. Inactive ChatGPT accounts will be removed on a periodic basis.

Account Termination

When you leave the University, your access to the Wharton ChatGPT account will end. All Wharton ChatGPT Edu account owners have a 14-day grace period after their University affiliation terminates before their ChatGPT account is terminated.

(ChatGPT retains a user's account for 30 days after their University affiliation ends, so if an account is restored before 30 days, all the user chats and history will be restored as well.)

Reminder: Bulk export of chat history or custom GPTs from the Wharton ChatGPT Edu workspace is not available.

Logging In

To log into ChatGPT Edu: [Read More ?](#)

Verifying You Are Logged Into Wharton's ChatGPT Edu Workspace

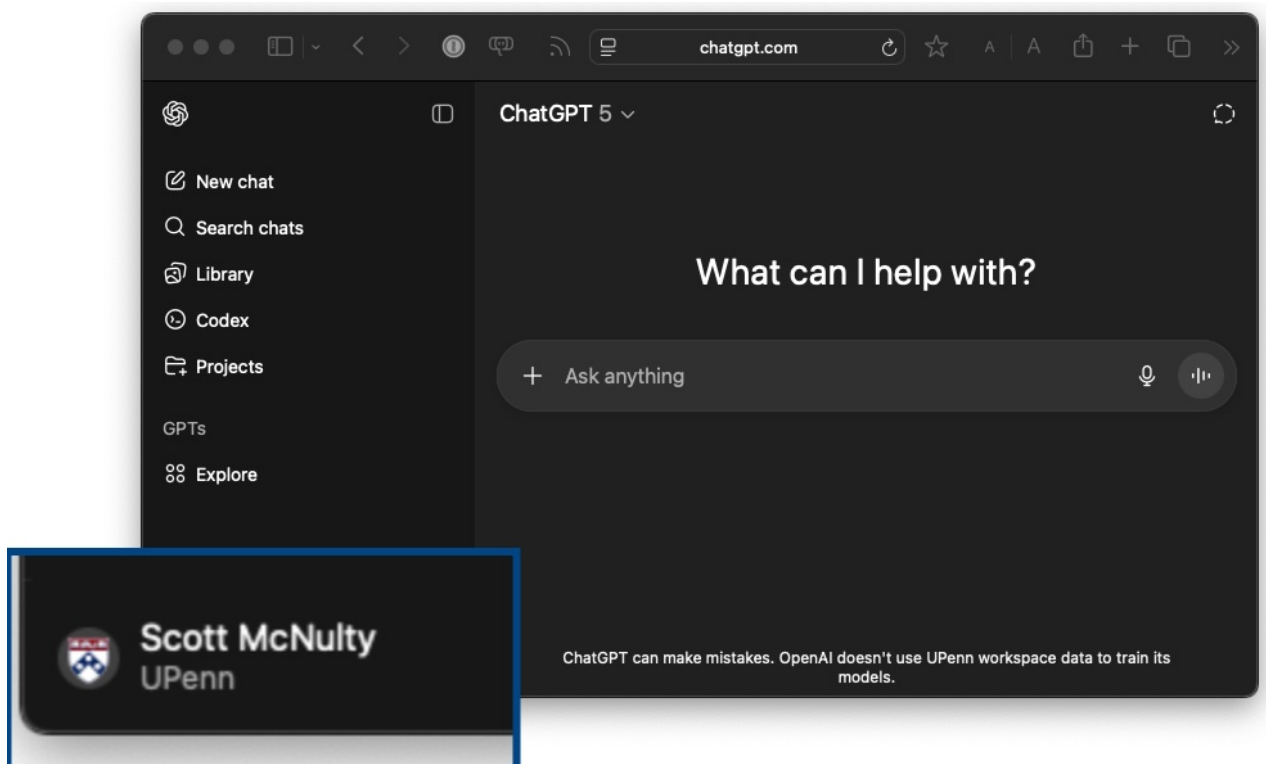

You may have more than one ChatGPT account, so it is important to know which account you're currently logged into, especially if you're using University data.

The Penn shield is displayed next to your name with "UPenn" underneath it at the bottom of the left sidebar when you're logged into Wharton'sGPT.

If you don't see the left sidebar it is probably hidden. Click the button at the top lefthand corner of the ChatGPT screen to expand the sidebar.

Already Have a ChatGPT account?

If you have a personal or paid ChatGPT account, we recommend that you create a distinct Wharton ChatGPT Edu for university-related business. This will ensure the data and intellectual property, both yours and the School's, is protected.

Please reach out to your **Wharton Computing Representative** for help migrating custom GPTs to your Wharton ChatGPT Edu account.

Security and Data

[Top](#)

The University's contract with OpenAI ensures that no data uploaded to Wharton's ChatGPT Edu workspace is used to train any of their AI models

REMINDER: Submission of University Confidential Data requires the use of a Penn/Wharton-approved enterprise generative AI tool, like ChatGTP Edu. Use of University Confidential Data in any other generative AI tool, whether a free or for-fee service, is prohibited.

Additionally, the contract includes data protections that enable ChatGPT Edu to be used with some kinds of data the University defines as confidential. The following table lists **university data** classifications and data types and if they can be used within Wharton ChatGPT Edu:

Data Type	Allowed in ChatGPT Edu
Low	
Yes.	
Moderate - Not Involving PII or FERPA data	
Yes - We recommend connecting with the Wharton Information Security Office on these usages of ChatGPT Edu.	
Moderate - Involving PII or FERPA data	
Yes, though you must engage with Wharton Information Security Office (ISO) for a risk review of the overall initiative's data architecture and flow outside of the AI solution.	
High*	
No. Data with this classification should not be uploaded to ChatGPT Edu. Contact the Wharton Information Security Office if you require using data that falls into this category.	
HIPAA/Protected Health Information	
No. HIPAA data should not be uploaded to ChatGPT Edu. Contact the Wharton Information Security Office if you require using HIPAA data.	

See: **Generative AI -- Best Practices and Resources** for additional resources about using Generative AI tools at Penn.

Note: Interactions with ChatGPT are subject to the University's **Acceptable Use Policy** and **Privacy in the Electronic Environment Policy**. These policies cover the privacy and use aspects of all technologies at Wharton.

ChatGPT Edu API Usage

Interconnection is the direct integration or connection between the AI tool and a system managed by the University. **Using the ChatGPT Edu API to interconnect to any University-managed system or application requires review by the **Wharton Information Security Office** and **Wharton Computing**.**

Managed system examples include (but are not limited to):

- Endpoints (Wharton Computing-managed computers, printers and other devices).
- Servers
- Applications (on-premise and cloud-based)
- Data Sources

- IoT Devices

[Top](#)

Features

Wharton's ChatGPT offering includes several features you may find useful.

Connectors

The following connectors are enabled for use with ChatGPT:

- GitHub Connector (This connector should only be used with University GitHub <https://github.isc.upenn.edu/>)
- Google Drive
- Microsoft OneDrive

Settings

The following settings are enabled for use with ChatGPT:

- Codex

[Top](#)

Resources

Video Tutorials: OpenAI has produced several short video tutorials:

- [Introduction to OpenAI, ChatGPT Edu, & Prompt Engineering](#) (15min)
- [Prompt Engineering](#) (7 min)
- [Introduction to GPTs \(Concept, Best Practices, Building\)](#) (5 min)
- [Advanced GPTs: Using Custom Actions](#) (5 min)
- [Quick High-Value Tips](#) (2 min)

Documentation: OpenAI has a lot of great documentation about ChatGPT Edu, but there are two resources that are particularly useful:

- [Prompt Engineering Best Practices](#): This is a must-read, as it offers many tips for crafting the perfect prompt.
- [GPTs for Business Cookbook](#): Creating your own GPT is a sort of superpower of ChatGPT Edu, and this cookbook walks you through the process and lays out some best practices.

Live Webinars: OpenAI provides recordings to webinars designed to introduce people to what ChatGPT Edu can do.

- ChatGPT Edu 101: [A Guide to Your AI Work Assistant](#). -This webinar includes an overview of the product, prompt engineering tips & tricks, advanced data analysis, and an intro to custom GPTs.
- ChatGPT 102: [Applying AI to Do Your Best Work](#) - This webinar covers using data analysis to improve critical thinking and building GPTs.

Student Opportunities: The Wharton AI & Analytics Initiative has [several resources for students](#), including:

- [Modules and Courses](#)
- [Engagement Opportunities](#)

- [Jobs and Internships](#)

[Top](#)

Questions?

Please contact your [Wharton Computing representative](#) with any questions regarding Wharton ChatGPT Edu.

Please contact Wharton's [Information Security Office](#) with any questions you may have about data policies and connecting ChatGPT Edu to University systems.
