

Firewalls: What They Are & Why Use Them

Last Modified on 04/23/2021 2:32 pm EDT

This article will give you an overview of what a firewall is, how it works, and will provide instructions on how to ensure your firewall(s) are enabled.

Faculty & Staff: For Wharton-imaged or Wharton-provided devices, you may not be able to change Firewall settings. For additional questions or requests, please reach out to your **IT support representative**.

What is a firewall?

1. A firewall is a network security system that establishes a barrier between a trusted, secure internal network and another network that may not be secure.
2. Additionally, a firewall can help prevent hackers or malicious software from gaining access to your computer through a network or the Internet. A firewall can also help stop your computer from sending malicious software to other computers.

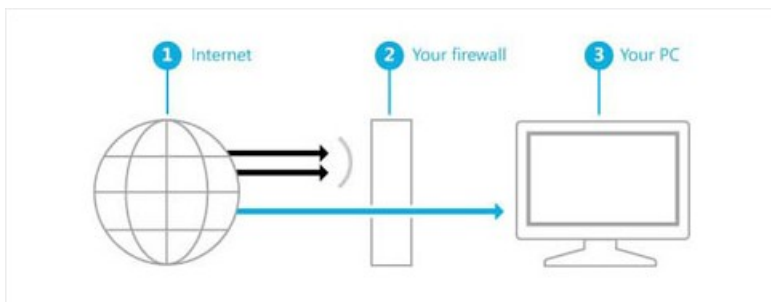

Enable/Disable Firewall

Warning: Only turn off your Firewall if you are installing a separate antivirus software that includes a firewall *and* active defender.

Windows

Follow Microsoft's directions on [how to turn your Firewall on or off](#).

MacOS

Follow Apple's directions on [how to turn your Firewall on or off](#).

Allow Trusted Applications

You can [allow applications you trust](#). Only choose this option for applications you know are safe.

Questions?

Students - [Wharton Computing Student Support](#)

Faculty - [Academic Distributed Representatives](#)

Staff - [Administrative Support](#)
